

Serial No.:

Year made:



## AVPP- Cartridge Filter Housing

**Wolftechnik Filtersysteme GmbH**  
Malsheimer Straße 67  
71263 Weil der Stadt  
Tel: ++44(0)7033-7014-0  
Fax: ++44(0)7033-7014-20  
eMail: [vertrieb@wolftechnik.de](mailto:vertrieb@wolftechnik.de)  
Internet: [www.wolftechnik.de](http://www.wolftechnik.de)



**Index**

1. Description	.....	page 3
2. Technical specification	.....	page 4/5
3. Safety instructions	.....	page 6
4. Installation	.....	page 7
5. Operation	.....	page 8
6. Filter exchange	.....	page 9/10
7. Maintenance	.....	page 11
8. Spare parts	.....	page 12/13
9. Notes	.....	page 14
8. CE-Declaration	.....	page 15

## 1. Description

### AVPP-SlimLine

AVPP SlimLine-Filter Housings are available in polypropylene, nylon or polypropylene and transparent SAN-ump. Different length of sumps from 5", 10" and 20" as well as different connection sizes from ¼", 3/8" to ½" round off the range of the AVPP-SlimLine series. One important feature of the AVPP-housings is the special inking of filter head and filter sump. According to the inking the version out of PP with blue sump and black filter head is designated AVPP-SlimLine-Blue. The nylon version is black and is designated AVPP-SlimLine-Black. AVPP-SlimLine-Clear is the designation of the filter housing with transparent sump and bright blue filter head.

### AVPP-Standard

AVPP-Standard-Filter Housings are like the AVPP-SlimLine available in polypropylene, nylon or polypropylene with transparent SAN-ump. Additionally a version in polypropylene-nature is available. All AVPP-Standard Housings have a ¾"-connection and sumps in 10" and 20" length. Excepting transparent sump out of SAN, which is available in 10" only. The different inking of filter head and filter sump is used for identifying and designation of the AVPP-housings. The version in polypropylene with blue sump and black filter head is designated AVPP-Standard-Blue. The nylon version is black and designated AVPP-Standard-Black. AVPP-Standard-Clear is the designation of the version with transparent sump and bright blue filter head. Housings out of polypropylene-nature are designated AVPP-Standard-nature

### AVPP-BigBlue

AVPP-BigBlue Filter Housings are designed for higher flow rates than the AVPP-Standard-Housings and they have connections size 1" and 1 ½". Special BigBlue Filter Elements with outside diameter of 110mm are available to meet the requirements of higher flow rates. By using an adapter to centre the inner diameter of the cartridges, all standard cartridges with smaller diameters can be placed in. AVPP-BigBlue-Housings are manufactured out of polypropylene and have a black filter head and a blue sump of 10" and 20" length.

Alle AVPP-BigBlue-Housings can be delivered with a bracket for mounting to the wall. For easier opening and closing of the housing sump when changing the filter element a key can be delivered.

2. Technical Specification

AVPP-SlimLine	-Blue	-Clear	-Black	-Natur
Inlet and outlet	¼", 3/8", ½"	¼", 3/8", ½"	½"	---
Operating pressure	10 bar @ 20°C	10 bar @ 20°C	10 bar @ 20°C	---
Operat. temperature	60°C @ 5bar	50°C @ 6.5bar	70°C @ 8.5bar	---
Material filter head	Polypropylen, black	Polypropylen, blue	Polyamid, black	---
Material sump	Polypropylen, blue	SAN, transparent	Polyamid, black	---
Material gaskets	Buna, Viton, EPDM	Buna, Viton, EPDM	Buna, Viton, EPDM	---
Length filter element	Typ 05: 4 7/8" Typ 10: 9 3/4" Typ 20: 20"	Typ 05: 4 7/8" Typ 10: 9 3/4" ---	--- Typ 10: 9 3/4" Typ 20: 20"	--- --- ---

AVPP-Standard	-Blue	-Clear	-Black	-Natur
Inlet and outlet	¾"	¾"	¾"	¾"
Operating pressure	max.10 bar @ 20°C	max. 10 bar @ 20°C	Max. 10 bar @ 20°C	max. 8 bar @ 20°C
Operat. temperature	max. 60°C @ 5bar	max. 50°C @ 6.5bar	Max. 70°C @ 8.5bar	max. 60°C @ 3bar
Material filter head	Polypropylen, black	Polypropylen, blue	Polyamid, black	Polypropylen, natur
Material sump	Polypropylen, blue	SAN, transparent	Polyamid, black	Polypropylen, natur
Material gasket	Buna, Viton, EPDM	Buna, Viton, EPDM	Buna, Viton, EPDM	Viton
Length filter element	Typ 10: 9 3/4" Typ 20: 20"	Typ 10: 9 3/4" ---	Typ 10: 9 3/4" Typ 20: 20"	Typ 10: 9 3/4" DOE Typ 12: 10" Code 5 Typ 20: 20" DOE Typ 20 : Code 3

AVPP-BigBlue	-Blue
Inlet and outlet	1", 1 ½"
Operating pressure	max. 8 bar @ 20°C
Operat. temperature	max. 60°C @ 3bar
Material filter head	Polypropylen, black
Material sump	Polypropylen, blue
Material gaskets	Buna, Viton, EPDM
Length filter element	Typ 10: 9 3/4" Typ 20: 20"

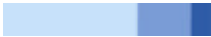

Type	- Blue		- Clear		- Black		- Natur	
	A	L	A	L	A	L	A	L
SlimLine								
AVPP05SLM	112	117	112	175	112	170		
AVPP10SLM	112	290	112	350				
AVPP20SLM	112	555			112	555		
Standard								
AVPP10STM	130	305			130	310		
AVPP12STM							118	305
AVPP20STM	130	565			130	570		
BigBlue								
AVPP10BBM	185	330			185	335		
AVPP20BBM	185	600			185	605		

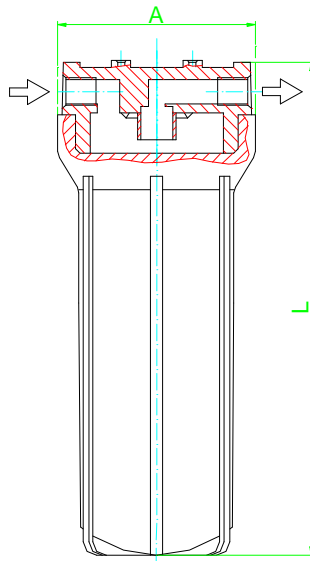

### 3. Safety Instructions

Fundamental and important instructions for your safety:

The cartridge filter housings type AVPP are determined for the filtration of liquids. Especially AVPP filter housings should not be used for:



- Liquids whose chemical resistance against the used materials is not guaranteed
- Liquids whose operation temperature is exceeding the maximum operation temperature shown in the technical specification.
- Liquids, whose operation pressure is exceeding the maximum operation pressure shown in the technical specification.

A different use or use over it has to be considered as not to be made under the arrangements. For damages resulting out of this the manufacturer does not accept the responsibility.

If you have to carry out maintenance services or repairs please notice the following instructions:

- The filter housing is a pressure vessel and can be under pressure.
- Before opening the filter housing please make sure, that the vessel is not under pressure and that all inlet and outlet lines to the vessel are closed.
- Protect all inlet and outlet lines against unintentional or unauthorised opening.
- When opening the housing take notice of all instructions which have to be observed when handling the hauling product ( e.g. protection clothes, no smoking ).
- Before restart of operation make sure, that all mechanical and other protection instruments are mounted tidy and that the vessel is closed orderly.



Please always think about your safety and therefore respect the company safety instructions and the regulations of the government when carrying out maintenance services or repairs at the filter housing.

#### 4. Installation

The inscription on the filter head shows the flow direction through the filter. The filter housing has to be installed in a hanging position, so that the pipe connections for inlet and outlet are located horizontal. The inlet line has to be connected to the inlet, the outlet line to the outlet. For tight sealing we recommend a PTFE sealing tape or a sealing paste suitable for medium and application. For controlling and monitoring the filter pressure drop for filter exchange it is recommended to install pressure gauges and shut off valves in front of and behind the filter housing. For draining the filter housing the drain plugs can be replaced by suitable ball valves.

Filter housings are delivered without filter elements!

The selection of the filter cartridges depends on the application and a precise specification can not be made in advance. The first equipment and exchange of filter cartridges should only be made with filter cartridges recommended by us or with filter cartridges suitable for medium, pressure, temperature and application.

Installation of filter cartridges ==> see 6.) filter exchange

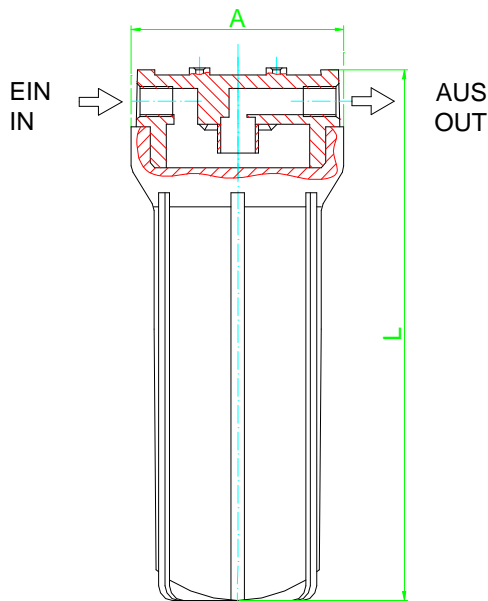



**5. Operation**

For start of operation and after filter exchange proceed as follows:

- Slightly open inlet to fill up the vessel
- The filter will be set under pressure now
- Check the filter housing for leakage
- In case of leakage close inlet and outlet again, open vent to discharge the pressure in the filter housing. Drain the liquid. Open the housing.
- Replace damaged parts. Restart operation again.
- If there is no leakage when setting under pressure first the outlet and then the inlet can be opened completely.
- The filter housing is now ready for operation.

Life time of the filter element is depending on the application. Generally the exchange of the filter element is recommended, if the maximum pressure drop of the filter cartridge is achieved. Generally the differential pressure for filter exchange is at 1.5 bar. In other cases the filter element should be replaced at least once a year.

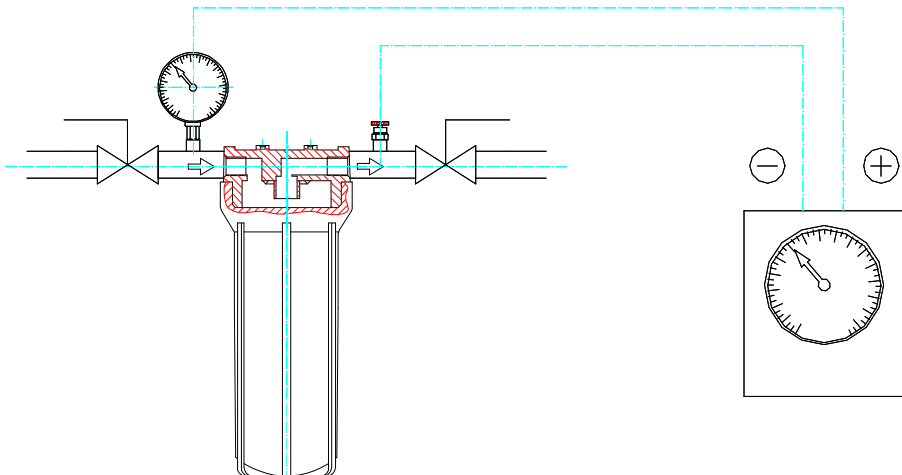

## 6. Filter exchange



If you have to replace the filter cartridge please take notice of the safety instructions on page 6 and the following

- The filter housing is a pressure vessel and can be under pressure.
- Before opening the filter housing please make sure, that the vessel is not under pressure and that all inlet and outlet lines to the vessel are closed.
- Protect all inlet and outlet lines against unintentional or unauthorised opening.
- When opening the housing take notice of all instructions which have to be observed when handling the hauling product. (e.g. protection clothes, no smoking...).
- Before restart of operation make sure, that all mechanical and other protection instruments are mounted tidy and that the vessel is closed orderly.

To exchange the filter cartridge proceed as follows:

- Close inlet and outlet
- Open filter housing
- Unscrew the sump and pull down.
- Take out the filter cartridge
- Clean housing if necessary
- Check all parts especially gaskets and sealing and replace if damaged
- Place new filter cartridge into the sump
- Screw sump to the housing
  
- Restart of operation ==> see 5.) Operation



1. Open housing



2. Exchange filter element



3. Close housing

## 7. Maintenance

During operation please take care of the following:

- max. operating pressure and max. operating temperature should not exceed.
- pressure shocks should be avoided.
- slightly open and close the vent to release air if necessary.
- max. differential pressure should not exceed and that the exchange of the filter element takes place in time
- no leakage is be found.
- the inspections are made according to the instructions.
- the company safety instructions and the regulations of the government are kept

If you have to carry out maintenance services or repairs please notice the following instructions:



- The filter housing is a pressure vessel and can be under pressure.
- Before opening the filter housing please make sure, that the vessel is not under pressure and that all inlet and outlet lines to the vessel are closed.
- Protect all inlet and outlet lines against unintentional or unauthorised opening.
- When opening the housing take notice of all instructions which have to be observed when handling the hauling product ( e.g. protection clothes, no smoking ).
- Before restart of operation make sure, that all mechanical and other protection instruments are mounted tidy and that the vessel is closed orderly.

Please always think about your safety and therefore respect the company safety instructions and the regulations of the government when carrying out maintenance services or repairs at the filter housing.

## 8. Spare parts

Pos.	Designation			Material	Order designation	Item-No.			
1	Head	- SLM	- Blue	PP, black	AVPP-KOPF-1/2SLM-S	000083			
					AVPP-KOPF-1/4SLM-S	000074			
					AVPP-KOPF-3/8SLM-S	000078			
			- Clear	PP, blue	AVPP-KOPF-1/2SLM-B	000085			
					AVPP-KOPF-1/4SLM-B	002825			
					AVPP-KOPF-3/8SLM-B	000080			
			- Black	PA, black	AVPP-KOPF-1/2SLM-BLACK	002559			
					- STM	- Blue	PP, black	AVPP-KOPF-3/4STM-S	000074
							- Clear	PP, blue	AVPP-KOPF-3/4STM-B
		- Natur	PP, natur	AVPP-KOPF-3/4STM-N			000104		
			- BBM	- Blue	PP, black	AVPP-KOPF1---BBM-S---HFP	000098		
AVPP-KOPF11/2BBM-S-HFP	000102								
2	O-Ring	- SLM		Buna	AVPP-ORBUN-SL	000140			
				Viton	AVPP-ORVIT-SL	000141			
				EPDM	AVPP-OREPR-SL	001183			
				Viton-FEP	AVPP-ORFEP-SL	003964			
		- STM		Buna	AVPP-ORBUN-ST	000142			
				Viton	AVPP-ORVIT-ST	000143			
				EPDM	AVPP-OREPR-ST	001184			
				Viton-FEP	AVPP-ORFEP-ST	004401			
		- BBM		Buna	AVPP-ORBUN-BB	001136			
				Viton	AVPP-ORVIT-BB	004721			
		EPDM	AVPP-OREPR-BB	001358					
3	Sump	- SLM	- Blue	PP, blue	AVPP-SUMPF05SL-B	000108			
					AVPP-SUMPF10SL-B	000115			
					AVPP-SUMPF20SL-B	000119			
			- Clear	PP, clear	AVPP-SUMPF05SL-C	000109			
					AVPP-SUMPF10SL-C	000116			
					AVPP-SUMPF20SL-C	004096			
		- Black	PA, black	AVPP-SUMPF10SL-S	004096				
				AVPP-SUMPF20SL-S	004095				
				- STM	- Blue	PP, blue	AVPP-SUMPF10ST-B	000111	
		AVPP-SUMPF20ST-B	000120						
		- Clear	PP, clear			AVPP-SUMPF10ST-C	000112		
		- Black	PA, black			AVPP-SUMPF10ST-R	000113		
			- Natur	PP, nature	AVPP-SUMPF10ST-N-A	000125			
- BBM	- Blue				PP, blue	AVPP-SUMPF10BB-B	000117		
					AVPP-SUMPF20BB-B	000118			
4	Bracket	- SLM		ALU with screws	AVPP-WINKEL-SL	000250			
		- STM			AVPP-WINKEL-ST	000251			
		- BBM			AVPP-WINKEL-BB-ALU	000252			
5	Key	- SLM		PP	AVPP-KEY-SL-SW1	000244			
		- STM			AVPP-KEY-ST-SW2	000245			
		- BBM			AVPP-KEY-BB-SW3	000246			

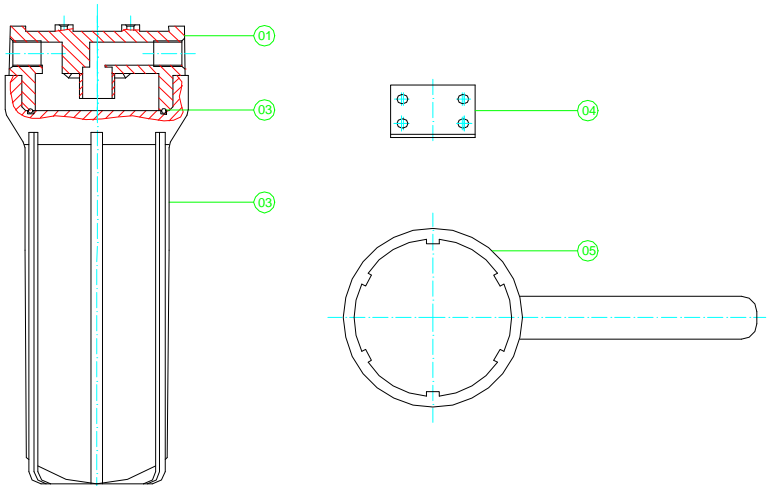
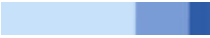



**9. Notes**

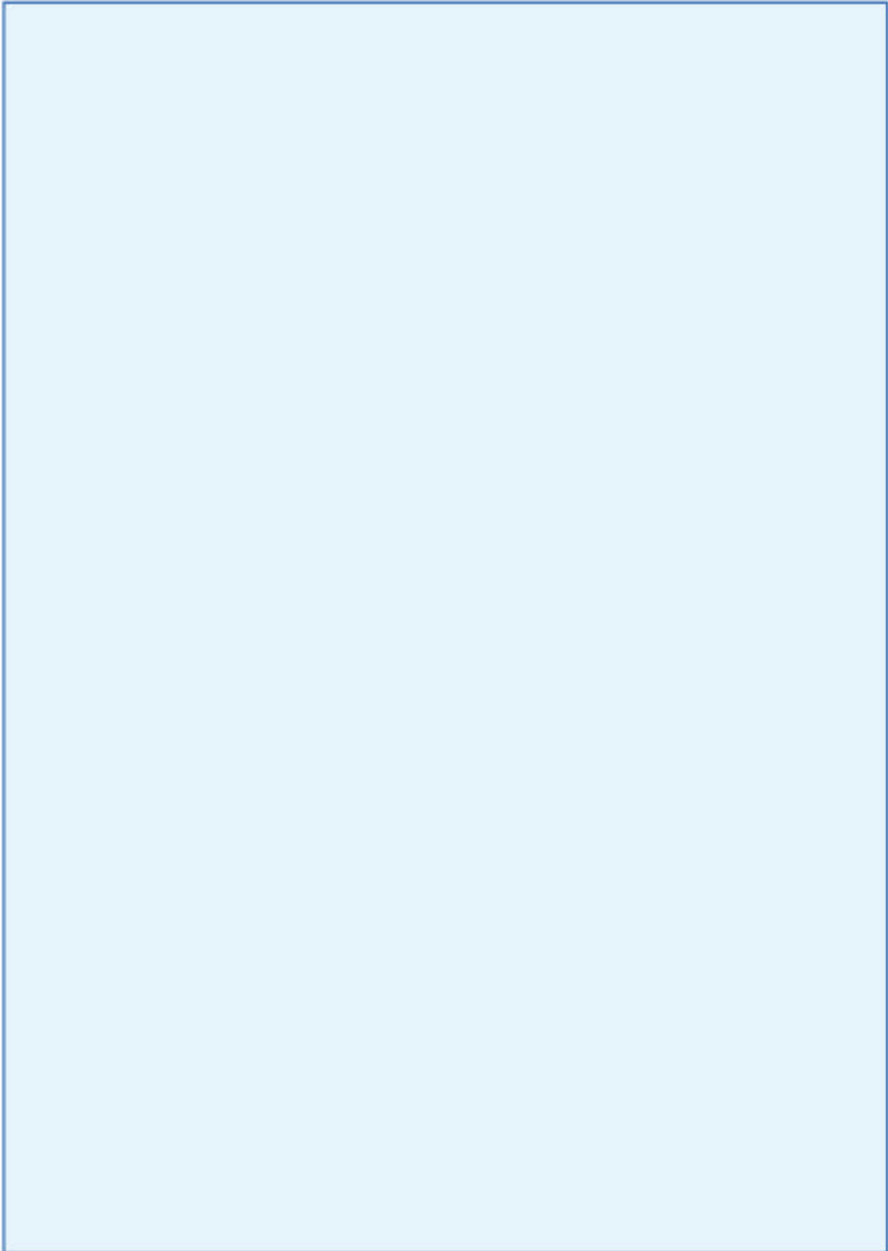

## 10. CE-Declaration of Conformity

### Declaration of Conformity

According to Annex II of Directive 97/23/EC

We,

Wolftechnik Filtersysteme GmbH  
Malmshheimerstraße 67  
71263 Weil der Stadt

declare that our product

**AVPP - Cartridge Filter Housing**

to which this declaration is referring to, is in compliance with the directive 97/23/EG and was subjected to the following conformity assessment procedure

Artikel 3, Abs. 3

The monitoring is performed by

TÜV SÜDWEST, CE-0036  
OR  
TÜV HESSEN, CE-0091

Weil der Stadt

(Name, Signature)



**Wolftechnik Filtersysteme GmbH**